

# Square loop ferrite memory core

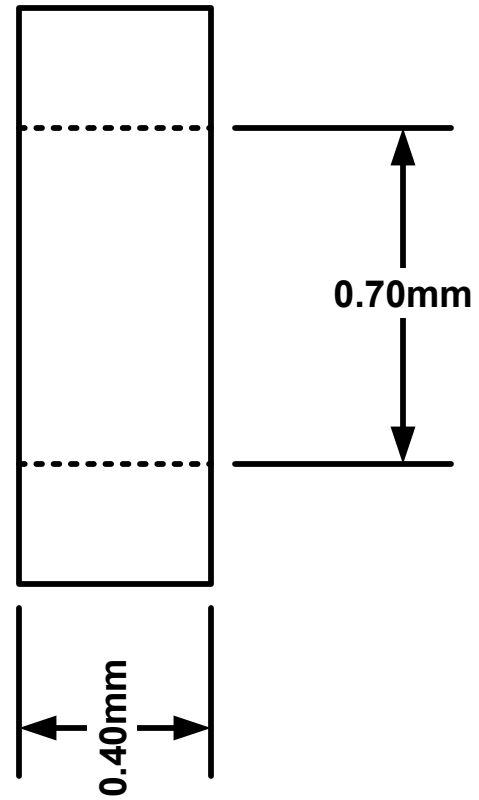
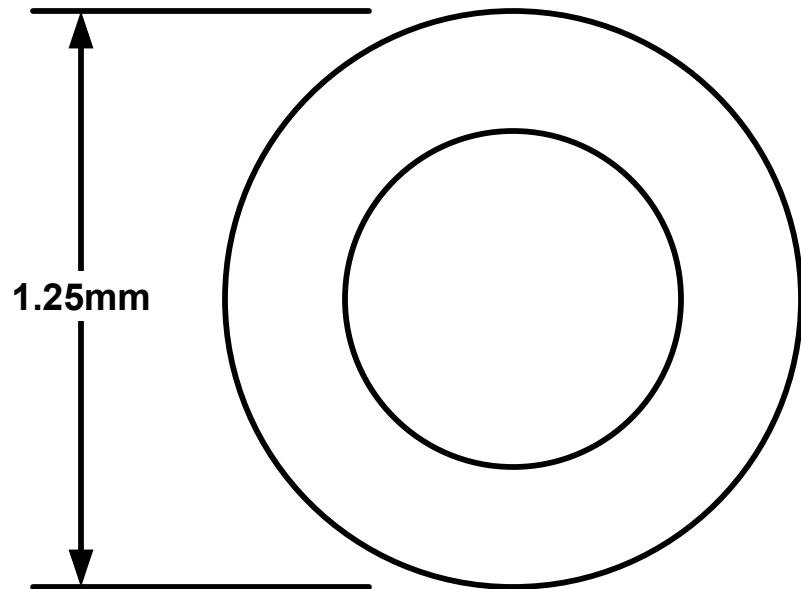

# Magnetizing current: Single turn primary and secondary

Polarity was Negative

300mA

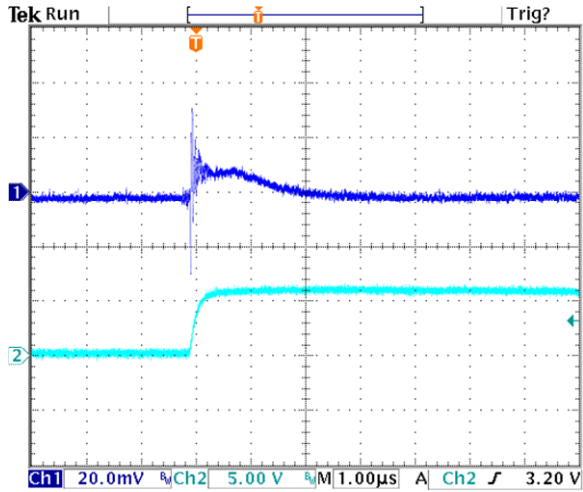

400mA

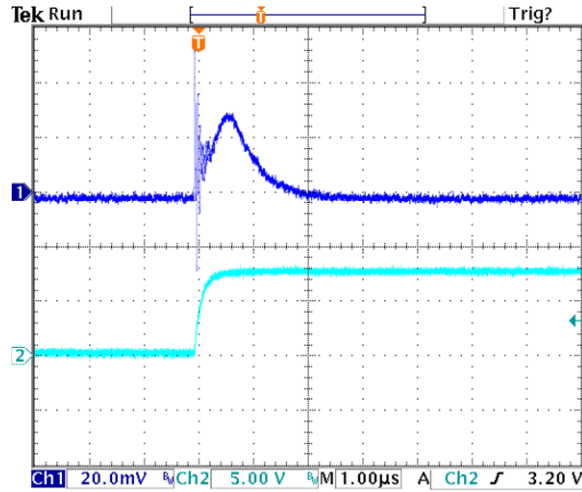

500mA

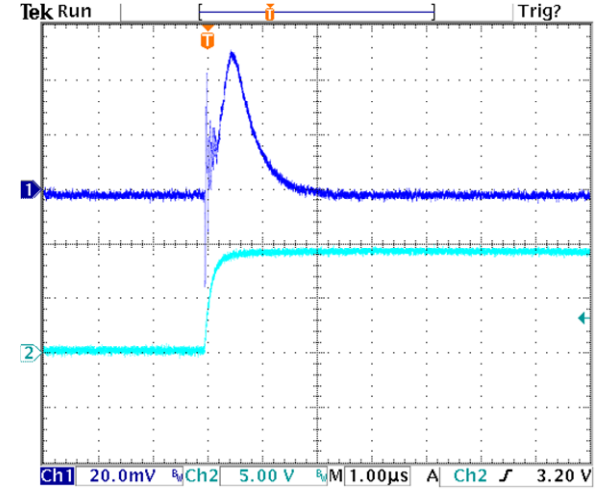

OUT  
IN

Polarity was Positive

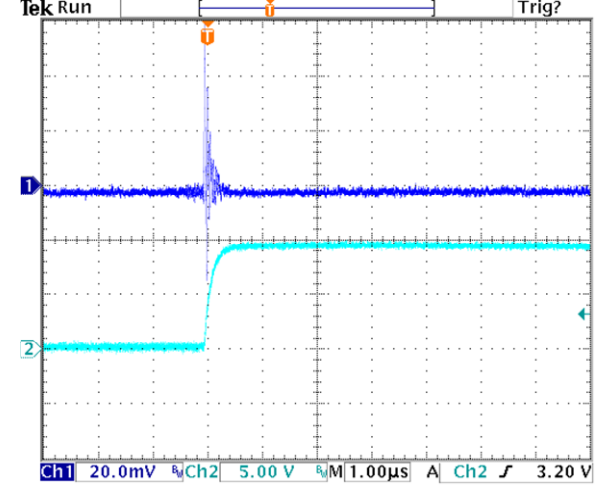
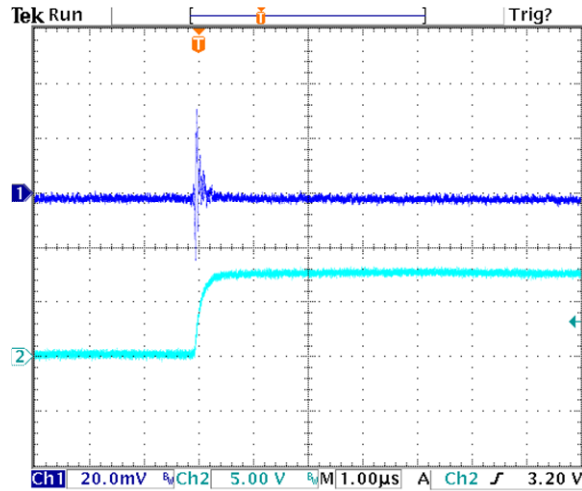
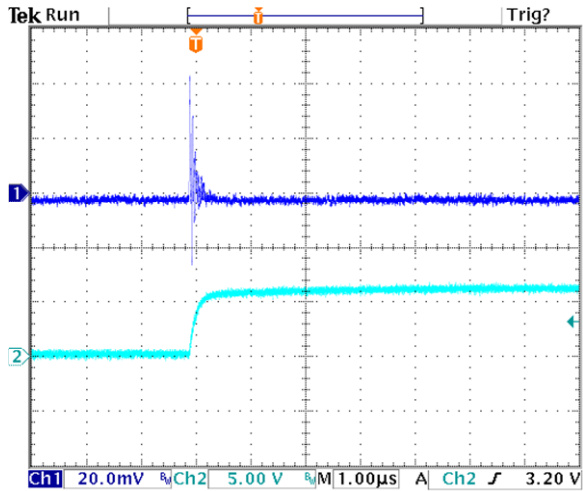

OUT  
IN

For coincident current operation, the sum of two primaries must be more than the minimum current but neither primary may be more than the minimum on its own.

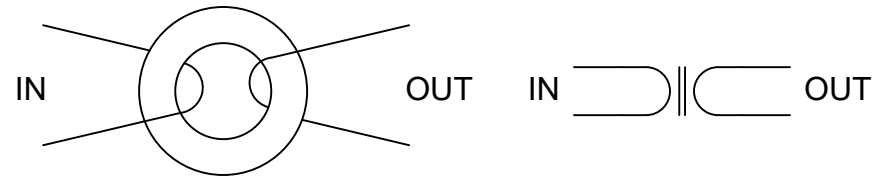

# Output signal boost: 3 turn vs 1 turn secondary, 1 turn primary

